

# IE HCOS Loaned Computers

## First Login - PC

All new PC laptops from the IE Program are Lenovo's L14s with Windows 11. All Gen 4 versions have been sent out with Windows 11 with a modified login to help simplify the process and have the necessary software pre-installed. Below are screenshots and instructions for the login process. The most important aspect is **NOT** to **connect** to the internet until the set-up is fully complete.

1. Turn on your Lenovo L14 computer - please have it plugged in and charging for the setup process.
2. **DO NOT** connect to the internet when prompted in the set-up. Click "I don't have internet".
  - a. If you do connect, Microsoft will require you to create or log in to a Microsoft account with your email and cell phone number.

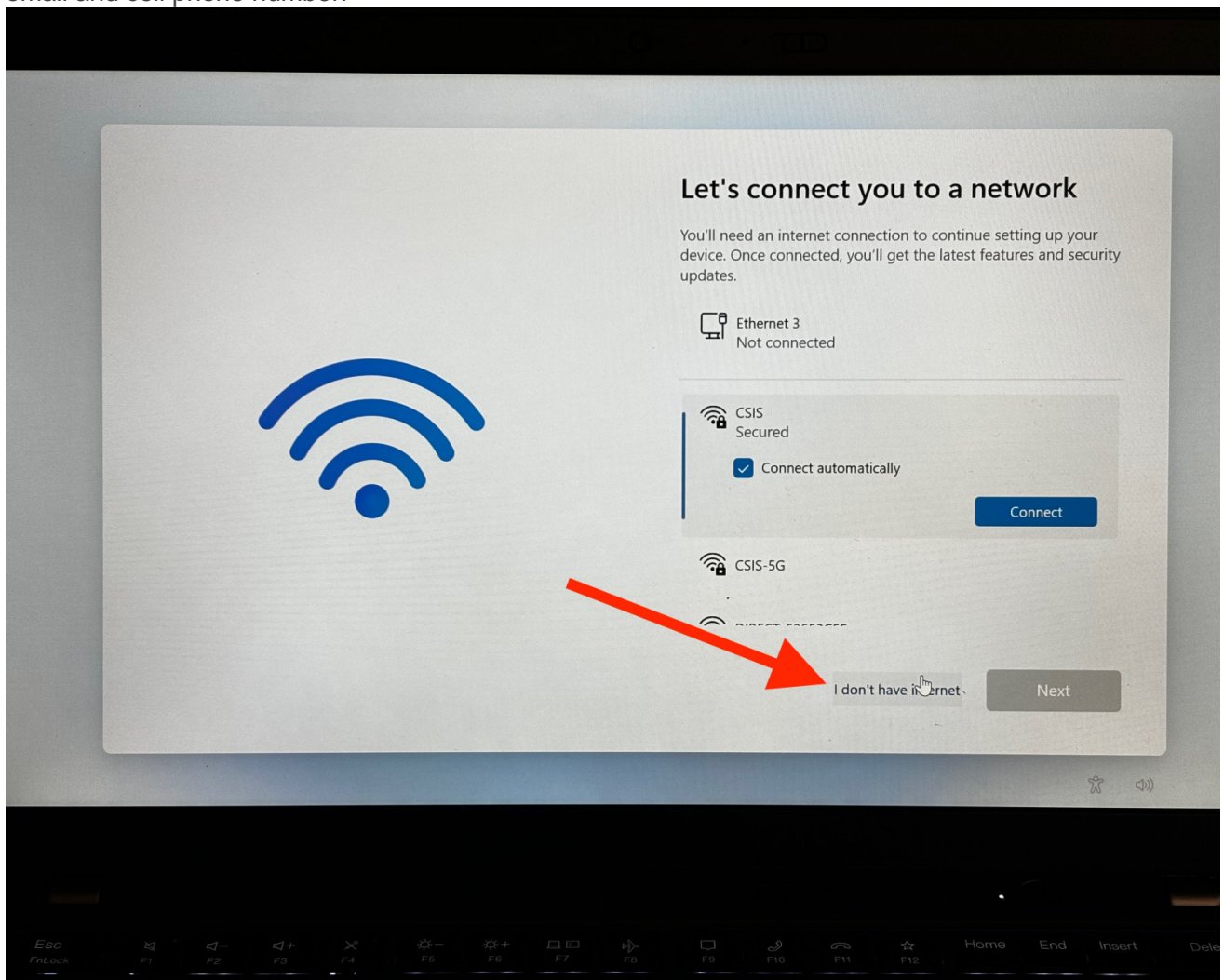

3. Please click the "Continue with limited setup". You can always change the settings later if needed.

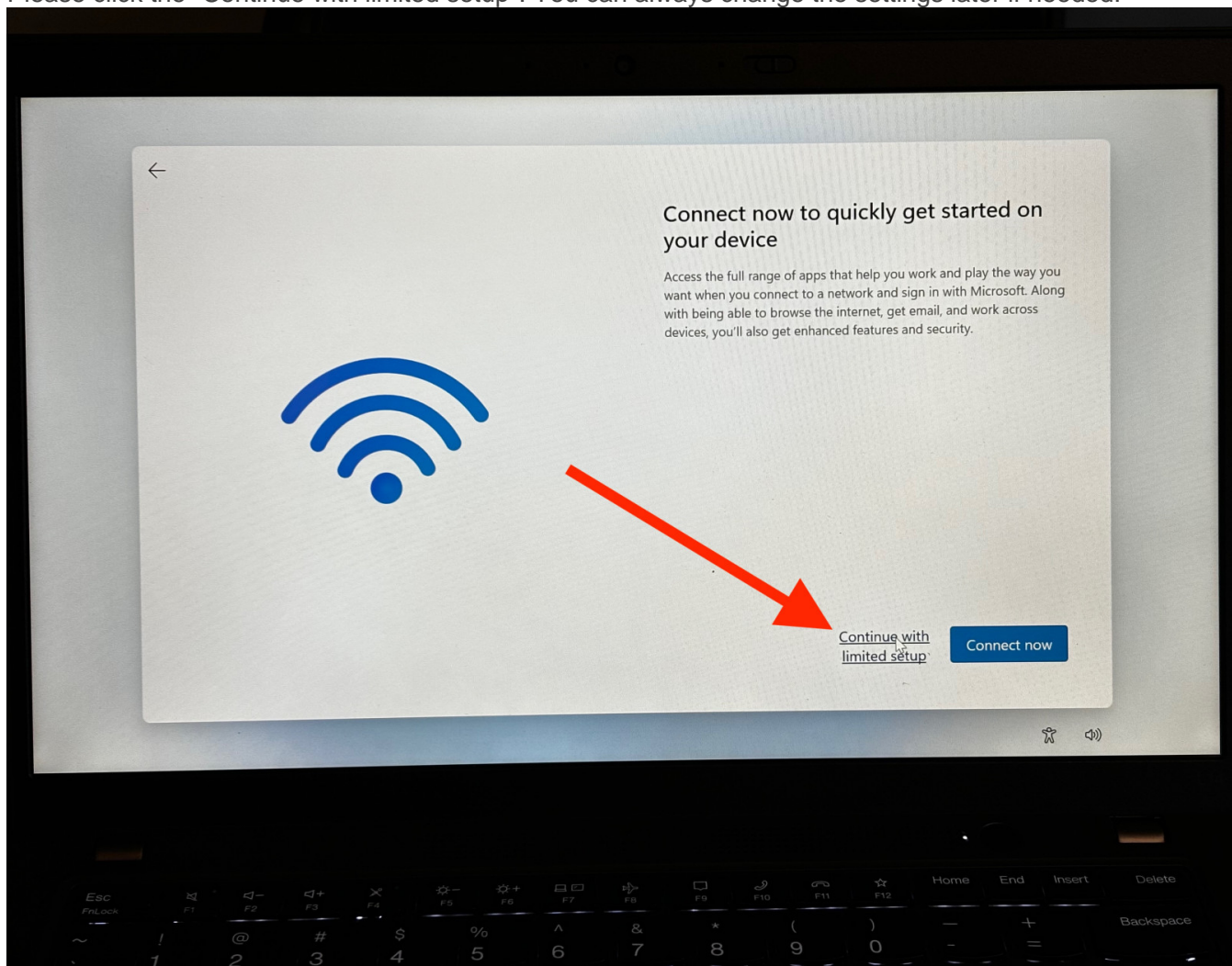

4. Type in the Student's Name.

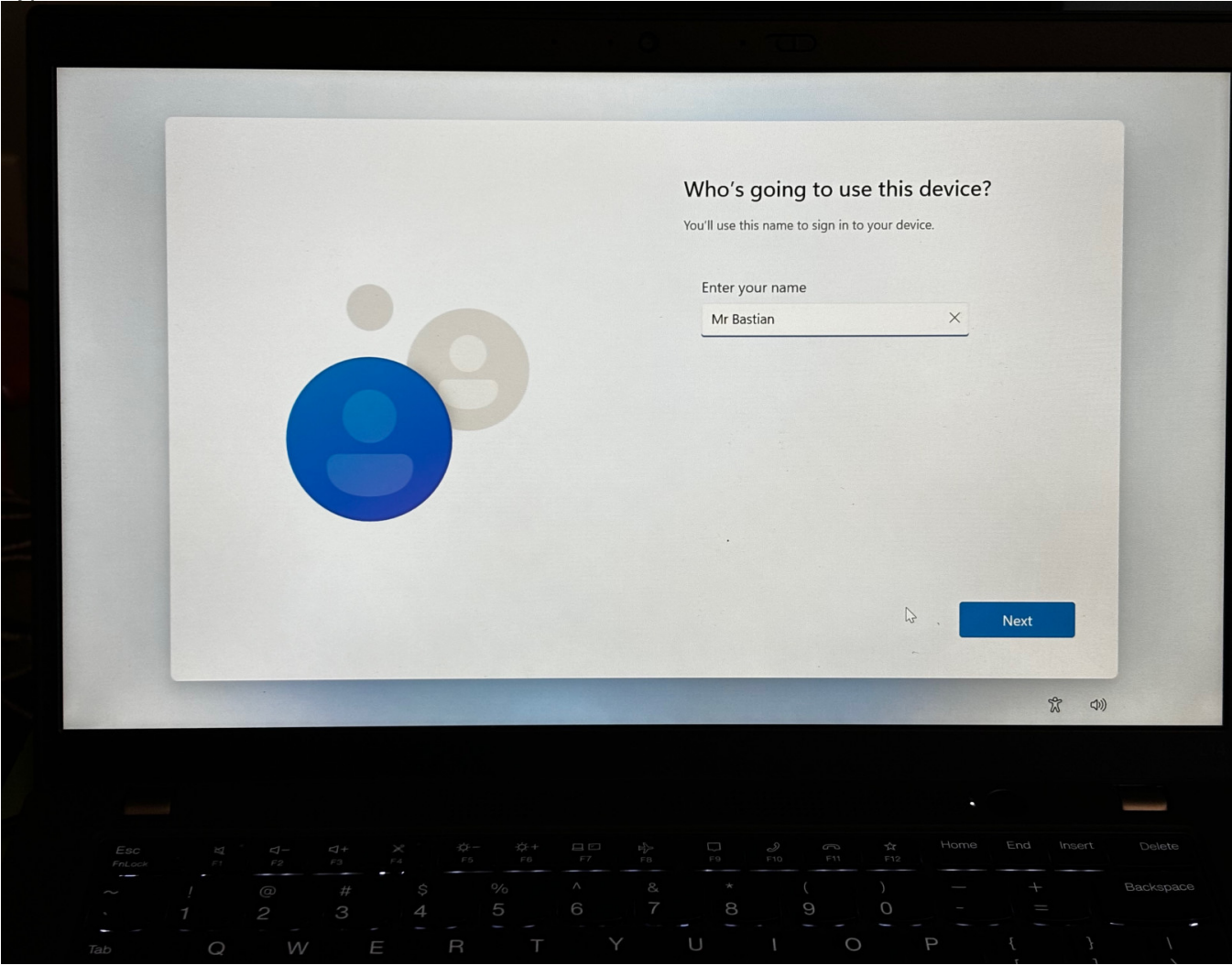

5. Create a memorable password for the student's account.

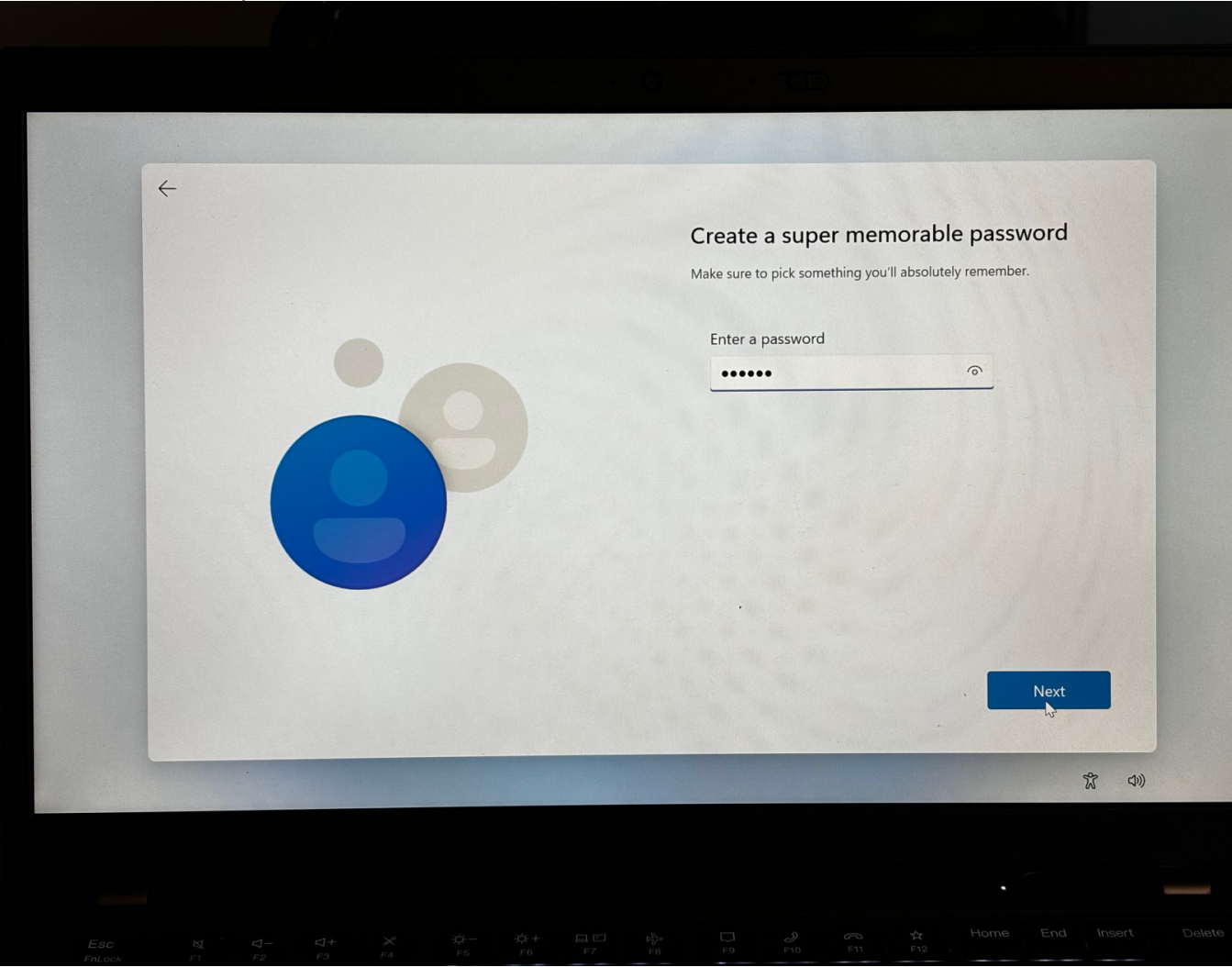

6. Confirm the Password.

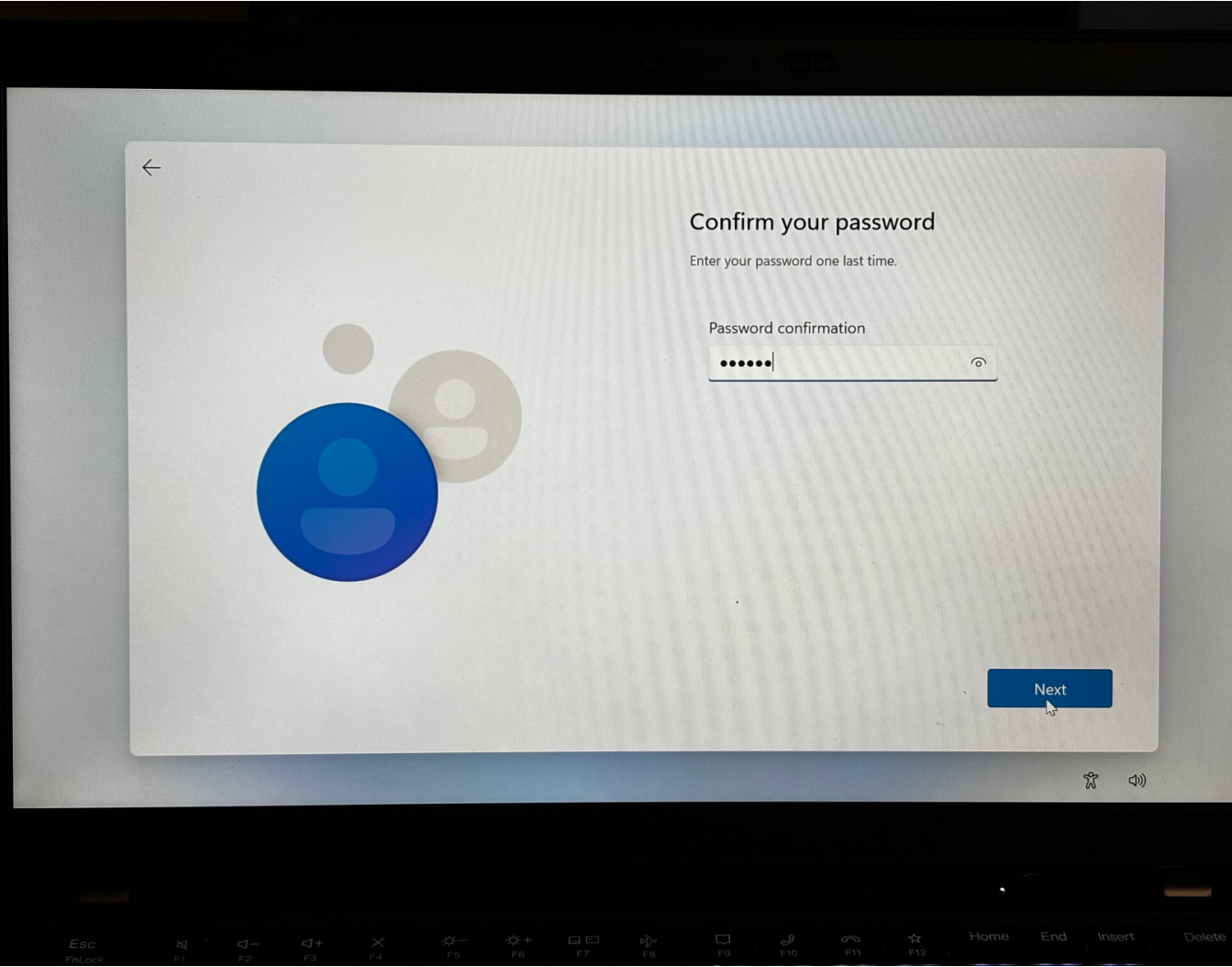

7. Add Security Questions (It will require **three different** questions with answers).

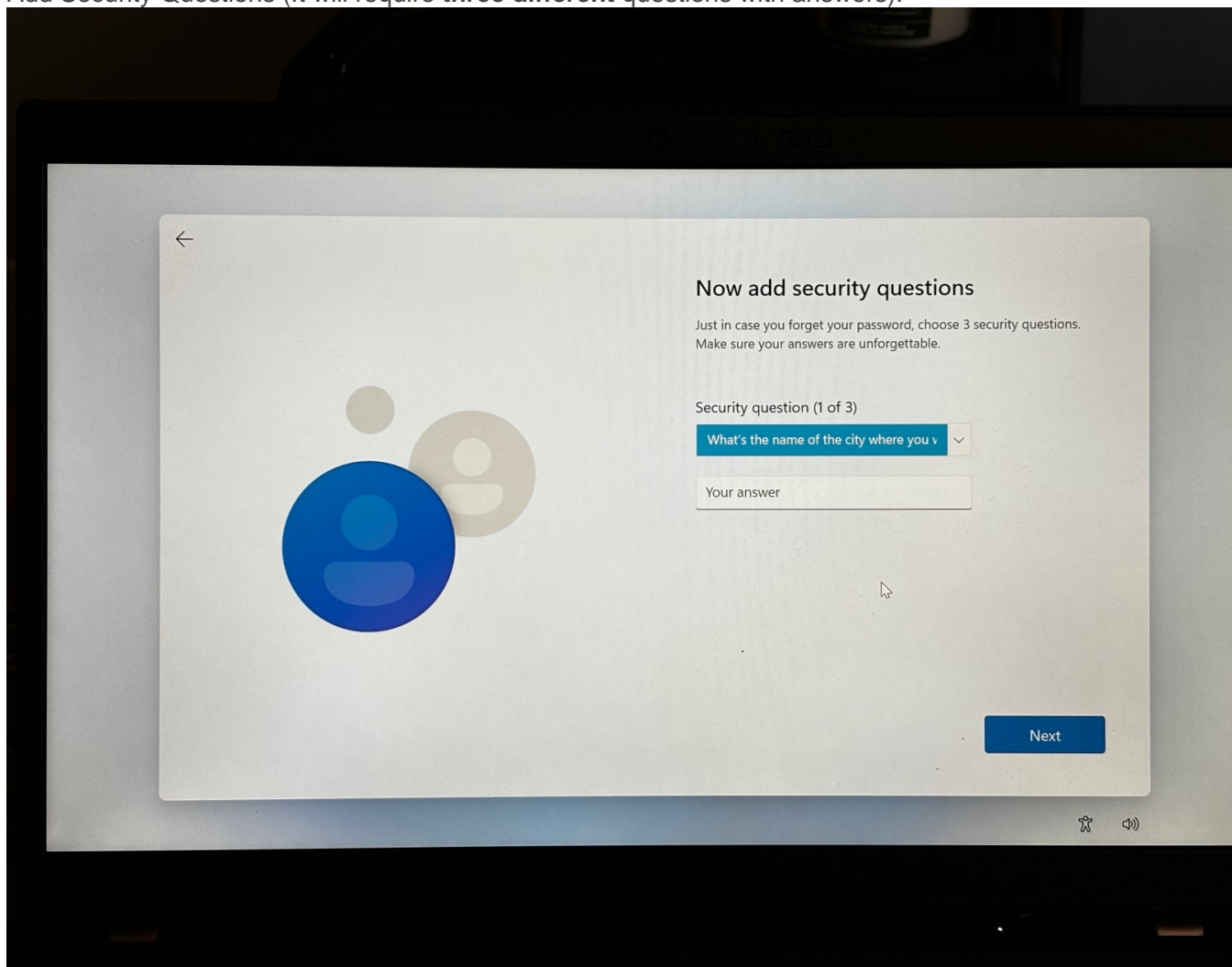

The screenshot shows the Windows Security Questions setup screen. On the left, there is a large blue circular profile picture placeholder. To its right, the text "Now add security questions" is displayed in bold. Below this, a smaller line of text reads: "Just in case you forget your password, choose 3 security questions. Make sure your answers are unforgettable." The main form area is titled "Security question (1 of 3)". It contains a dropdown menu with the text "What's the name of the city where you v" and a small downward arrow. Below the dropdown is a text input field labeled "Your answer". At the bottom right of the form, there is a blue button labeled "Next". In the bottom right corner of the screen, there are small icons for a person and a speaker.

←

### Now add security questions

Just in case you forget your password, choose 3 security questions.  
Make sure your answers are unforgettable.

Security question (1 of 3)

What's the name of the city where you v

Your answer

Next

8. The L14 laptop has a fingerprint sensor; you may add that to the computer for a simpler login instead of needing a password each time. You may also choose "Skip for Now". The Sensor is the power button on the right side above the keyboard.

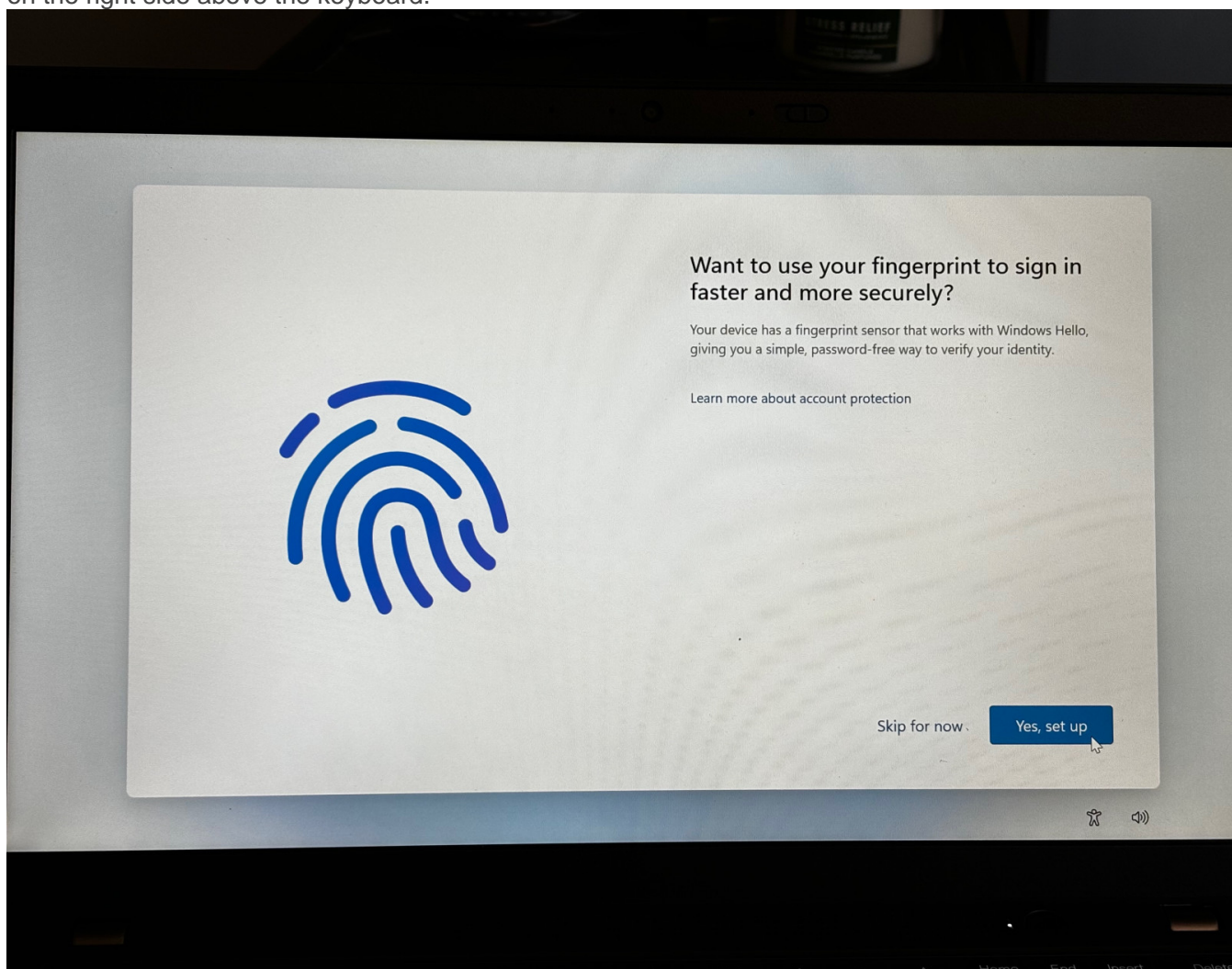

9. You will need to create a memorable PIN for your login. Please keep this number saved and safe.

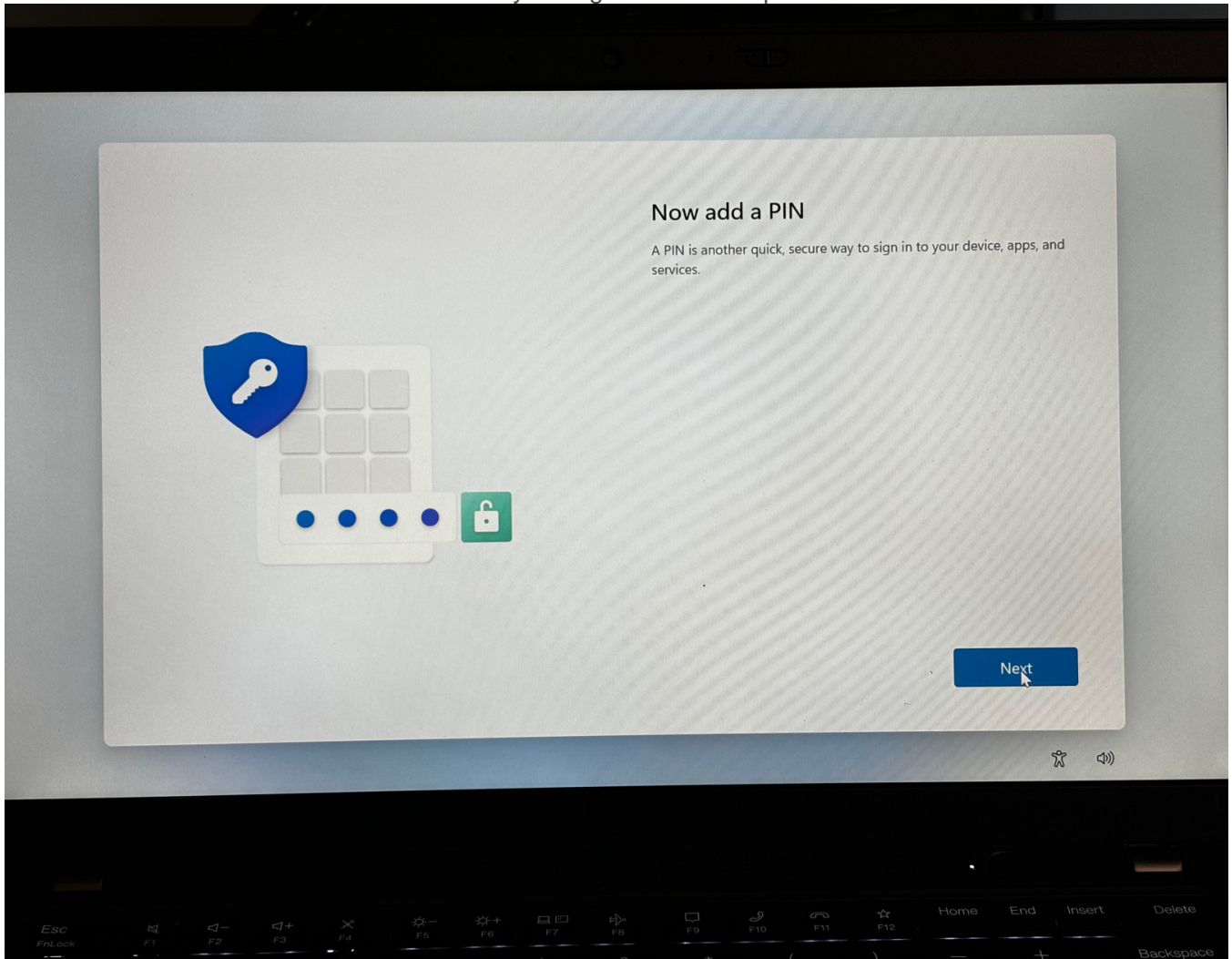

10. The computer should now bring you into the normal Windows start-up. Once the computer has opened, you may now connect to the internet. We recommend the first thing you do is go into Windows Security and ensure Virus Threat and Protection is turned on and updated.
11. If you have questions or need help, please contact [tickets@onlineschool.ca](mailto:tickets@onlineschool.ca) for help.

Revision #6

Created 4 January 2024 18:24:41 by Steve Bastian

Updated 8 January 2024 16:40:23 by Steve Bastian